



UNIVERSITY  
OF APPLIED SCIENCES  
UPPER AUSTRIA



Program

# International Days in SOCIAL WORK

3 – 7 June 2024

Add on week: until 14 June 2024

University of Applied Sciences Upper Austria  
School of Medical Engineering & Applied Social Sciences

Garnisonstrasse 21 • 4020 Linz/Austria  
Tel.: +43 5 0804-54060 • [international@fh-linz.at](mailto:international@fh-linz.at)

**Aim**

→ higher



# Organizing Team



## FH-Prof. DSA MMag. Dr. Christian Stark

Head of Studies Social Work Program,  
Dean at Linz Campus

Phone: +43 5 0804 52710  
E-Mail: christian.stark@fh-linz.at



## Mag. Iwona Hunstorfer

Head of International Office

Phone: +43 5 0804 54060  
E-Mail: iwona.hunstorfer@fh-linz.at



## Mag. Brigitte Brandstätter

International Office Assistant

Phone: +43 5 0804 54061  
E-Mail: brigitte.brandstaetter@fh-linz.at

Postal Address:  
University of Applied Sciences Upper Austria  
School of Medical Engineering and  
Applied Social Sciences  
Garrisonstrasse 21  
4020 Linz / Austria

# International Days in Social Work

The University of Applied Sciences Upper Austria (FH Upper Austria) offers practically oriented degree programs which have been carefully put together to meet the needs of industry and society. Each of our four schools is characterized by its own distinctive profile and special field of study. The individual locations focus on the areas Informatics, Communications and Media (Hagenberg Campus), Medical Engineering and Applied Social Sciences (Linz Campus), Business and Management (Steyr Campus) and Engineering (Wels Campus).

With its Bachelor's and Master's degree programs, the Department of Social Work offers interdisciplinary training for future professionals who are able to advise, accompany and support service users and plan assistance processes. Both degree programs ensure a practice-oriented education. The Master's program also focuses on intercultural competence. Thus, internationalization is an important part of the training. Our students and staff have the opportunity and are encouraged to go abroad for exchange semesters and internships, to visit partner universities and to participate in excursions to social work organizations abroad. Internationalization at home is another way to get an insight into social work abroad and to learn more about different approaches in the different subject areas of social work.

In order to foster the international experience in the social field within our institution, to discuss and explore various topics important to our international guests, the Department of Social Work and the International Office Linz are happy to welcome you for a 5-day program of lectures, workshops and cultural activities – offering everyone the chance to meet people from different countries and to look at Social Work from an international and intercultural perspective. In addition, we will visit social organizations active in a variety of different areas, such as youth work, immigration, or violence prevention.

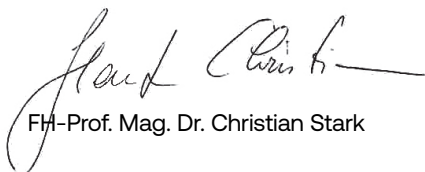

FH-Prof. Mag. Dr. Christian Stark

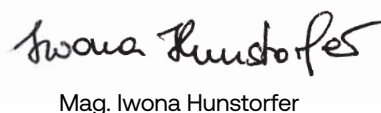

Mag. Iwona Hunstorfer

# University of Applied Sciences Upper Austria (FH Upper Austria)

The University of Applied Sciences Upper Austria is the largest university of applied sciences in Austria and is an integral part of the tertiary education system. The organization is defined by the requirements of regional employment and research needs. Four locations in Upper Austria's central area offer innovative and interdisciplinary academic degrees, each with a different focus.

- School of Informatics, Communications and Media - Hagenberg Campus
- School of Medical Engineering and Applied Social Sciences - Linz Campus
- School of Business and Management - Steyr Campus
- School of Engineering - Wels Campus

You will find more information at:  
[www.fh-ooe.com](http://www.fh-ooe.com)





# School of Medical Engineering and Applied Social Sciences

The focus in Linz is Medical Engineering and Applied Social Sciences. Our aim is to prepare students for the leadership positions of the future. Because our programs are designed around a common theme, the synergy effects are obvious: more knowledge and a multitude of partner organizations, such as the Austrian Red Cross, leading charities and numerous human services organizations and companies such as Otto Bock.

All degree programs combine comprehensive training with practice. The School of Medical Engineering and Applied Social Sciences offers study programs at undergraduate (bachelor´s) and graduate (master´s) level.

**Medical Engineering (BA/MA)** combines medicine and medical device technology and prepares students to bridge the gap as Medical Engineers.

**Social Work (BA/MA)** trains students to advice and counsel people in distress and enables graduates to plan and organize the helping process.

**Social-, Public- and Nonprofit-Management (BA)** is a business degree program that is geared towards the realities of the social and health, the public and the non-profit sectors.

**Applied Technologies for Medical Diagnostics (MA)** covers a new professional area at the intersection of engineering, natural sciences, and technology-oriented health professions, neatly filling the gap between development engineering and the application of medical devices.

**Leading Transformation for Impact Organizations (MA)** combines sustainability and digitalization with leadership and organizational change.

**Managing Nonprofit and Public Services (MA)** offers an industry-specific general management education with a focus on non-profit organizations and public institutions.

# Program

## → Monday, 3 June 2024

---

- 7:45 Departure from FH Upper Austria for trip to Sankt Wolfgang  
18:30 Arrival back in Linz
- 

## → Tuesday, 4 June 2024

---

- 8:30 Registration
- 9:30 Welcome & Introduction: Christian Stark (Dean, FH Upper Austria) **HS2**
- 10:00 Organizational: Iwona Hunstorfer (Head of International Office, FH Upper Austria) **HS2**
- 10:15 Group Picture / Break
- 10:30 Lecture / Workshop:
- Susan Rose / Hanna Raitakari: Social Workers as Local Legislators: The Experience of a Finnish and a US Social Worker **HS2**
  - Anne Vande Berg / Ann Lichliter: Using Art for Self-care and for Connecting with Clients **SR A-205**
  - Seda Attepe Özden: Social Work Education in Turkey: Challenges and Perspectives **HS7**
  - Lilit Askaryan / Nune Geghamyan: Social Work in Post War Reality in Armenia (max. participants: 12) **SR A-203**
- 12:00 World Café  
Introduce yourself and your home university and get to know other participants, share local food from your country, what is your hometown/country known for?
- 14:00 Social Work from International Perspective **HS2**  
Discuss / work in groups
- 15:30 Welcome Late Lunch
- 

## → Wednesday, 5 June 2024 (part 1)

---

- 9:00 Lecture / Workshop:
- Kelly Melekis: Transformative Social Work: Constructing a Practice Stance **SR A-203**
  - Johanna Jussila / Miia Heikkinen / Ann-Mari Sippu: Methods of Reflecting Interpersonal Skills (max. participants: 36 – 3x12) **SR D-101, SR D-102/103, SR D-104**
  - Annette Plobner: Constellation Work with Psychodrama as a Method in Social Work (max. participants: 16) **SR A-205**
  - Seval Bekiroglu: Turkish Mental Health Policy: Challenges for People with Severe Mental Illness **HS7**
- 10:30 Break
- 10:45 Lecture / Workshop:
- Timothy Dueck: Drawing from the Classroom: Co-constructing Experiential Knowledge in Social Work Academia **HS7**
  - Jaap Bruijn: From Political Advocacy to Personal Counselling and Back to Social Activism: The Dutch Journey of Social Work **SR A-203**
  - Tatevik Karapetyan: Community based Social Work Centers **SR A-205**
  - Amy Kirby: An Exploration of Trauma-Informed Care: from Milwaukee, Wisconsin to the World **HS2**
-

# Program

## → Wednesday, 5 June 2024 (part 2)

---

12:00 Lunch Break

13:00 Presentation / Site Visit:

- SOS Human Rights (Social Work with Asylum Seekers)
- Center for Family Therapy and Men's Counselling Center
- Neustart (Social Work with Offenders)

HS7

18:30 Dinner for Lecturers

---

## → Thursday, 6 June 2024

---

9:00 Lecture / Workshop:

- Charlotte Wekker: Just kidding! - About everyday Racism in Higher Vocational Education
- Mikael Bengtsson: Social Work as a Profession – the Case of Sweden and other Nations/States
- Ingrid Baloun / Jana Stejskalová: Measuring Quality of Life (max. participants: 30)
- Yazmin Mendoza Reyes: Community Intervention Model in México With a Measurable Social Impact

SR A-203

HS7

SR A-205

SR A-207

10:30 Break

10:45 Lecture / Workshop:

- Dovilė Daugėlienė: Ageism: Definition, Manifestation and Implications
- Eva Krizova: Spirituality Today - Exploratory Techniques and Use in Social Work (max. participants: 25)
- Terhi Kärpänen / Outi Loikkanen: The Service Design for Social Impact (max. participants: 40)
- Sylvia Enríquez Cordero: The Importance of Disability Awareness (max. participants: 40)

HS7

SR A-203

SR A-205

SR A-207

12:00 Lunch Break

13:00 Presentation / Site Visit:

- Exit Sozial (Forensic Residential Facility)
  - Notschlafstelle B37 (Night Shelter for Homeless People)
  - Verein ISI (Outreach Work)
- 

## → Friday, 7 June 2024

---

8:45 Departure from FH Upper Austria

9:30 Guided tour:

Historical Site – Former Concentration Camp Mauthausen (optional)  
Participants of the two-week program: free morning

13:00 Closing Session and Evaluation

HS2

14:00 Farewell lunch

---

# Cultural Day

→ Monday, 3 June 2024

---

## Schafbergbahn

Austria's STEEPEST COG RAILWAY has been running from St. Wolfgang up the Schafberg since 1893. The train takes 35 minutes to cover a total distance of 5.85 kilometers, rising 1190 vertical meters. The journey to the top of the Schafberg starts at the valley station in St. Wolfgang. After approximately 30 minutes of travel time and 4.2 km of distance, the cog railway reaches the Schafbergalm station at 1,364 meters. This stop also marks the treeline of the Schafberg. From Schafbergalm, it takes another 10 minutes to reach the top by train. Once there at the mountain station, you can admire one of the most beautiful mountain panoramas in Austria.



---

## WolfgangseeSchiffahrt

SHIP, AHOI! The WolfgangseeSchiffahrt ferries have been sailing the waters between the idyllic towns of St. Wolfgang, St. Gilgen and Strobl for more than 150 years. The fleet consists of four modern ships and a nostalgia ship and runs regularly from spring to autumn.





# Lectures and Workshops

→ Tuesday, 4 June 2024

---

**Susan Rose / Hanna Raitakari**

University of Wisconsin-Milwaukee (USA) / Satakunta University of Applied Sciences (Finland)

## Social Workers as Local Legislators: The Experience of a Finnish and a US Social Worker

This workshop will

- (1) present a rationale for social workers to engage in the political process by gaining elective office themselves,
  - (2) describe the experiences of a social worker elected to the Municipal Council in Pori, Finland and a social worker elected to the City Council in a Chicago suburb,
  - (3) allow participants to discuss local elections in their own communities and how they could engage in that process themselves.
- 

**Anne Vande Berg / Ann Lichliter**

Winona State University (USA)

## Using Art for Self-care and for Connecting with Clients

This workshop is an interactive presentation. Participants will learn about the benefits of using art as a means for self-care and for connecting with clients. This workshop is for individuals wishing to enhance their own self-care and learn new strategies to connect with clients of all ages. No art experience is needed.

---

**Seda Attepe Özden**

Baskent University (Turkey)

## Social Work Education in Turkey: Challenges and Perspectives

Social work education was established in 1961 in Turkey. Over 70 universities are teaching social work now in BA and MA degrees. Although the number of study programs increased throughout the years, the quality of social work education has not passed a long way. Many challenges and problems of social work education in the country remain unresolved.

---



# Lectures and Workshops

---

**Lilit Askaryan / Nune Geghamyan**  
Yerevan State University (Armenia)

## Social Work in Post War Reality in Armenia

The war of 2020 and 2023, the post-war reality also created challenges for social workers. Working in emergency situations, at the same time bearing almost the same socio-psychological weight, social work specialists had to go through unusual experiences. Social workers in RA today have losses, challenges and many lessons learned.

---

## → Wednesday, 5 June 2024

---

**Kelly Melekis**  
University of Vermont (USA)

## Transformative Social Work: Constructing a Practice Stance

Transformative change is viewed as relational, profound, and generative. In this workshop, we will explore the potential of adopting a transformative social work stance constituted by connecting three philosophical tenets: (a) human rights & social justice, (b) a strengths perspective, and (c) critical social constructionism. Participants will have opportunities to explore their practice stance, with attention to epistemological, ethical, and relational dimensions. We will also consider potential facilitators and barriers to implementation of our preferred stance.

---

**Johanna Jussila / Miia Heikkinen/ Ann-Mari Sippu**  
South-Eastern Finland University of Applied Sciences (Finland)

## Methods of Reflecting Interpersonal Skills

In this workshop, we practice reflection on professional interpersonal skills and ethical issues using case examples and different methods.

---

**Annette Plobner**  
Hannover University of Applied Sciences (Germany)

## Constellation Work with Psychodrama as a Method in Social Work

Seeing people as part of a social network, this workshop gives an impression and orientation of constellation work. Finding a good and right position in the respective social context is generally important as a central issue in group contexts as in teams, organizations, families. How do people relate to each other? What happens between people? By a practical example of the participants (organigram – individual network – case work) constellation work will be experienced.

---

# Lectures and Workshops

→ Wednesday, 5 June 2024

---

**Seval Bekiroglu**

Baskent University (Turkey)

## Turkish Mental Health Policy: Challenges for People with Severe Mental Illness

The provision of mental health services in Turkey faces numerous challenges. People with SMI are a particularly affected group. In contrast to other parts of the world, community mental health services for people with SMI have only been in place in Turkey since the 2010s. However, these services are not sufficient to support individuals with ADRH in sustaining their lives independently. This study presents community-based mental health services for individuals with ADRH in Turkey, including numerical data on the mental health system and practical experiences.

---

**Timothy Dueck**

University of the Fraser Valley (Canada)

## Drawing from the Classroom: Co-constructing Experiential Knowledge in Social Work Academia

Social work education in the classroom generally focusses on learning from textbooks, journal articles, and other traditional sources of knowledge to inform curricula. While classroom discussions can provide opportunities for students and instructors to share their own thoughts, experiential knowledge is not often intentionally solicited in a formal manner. This workshop demonstrates ways to strategically integrate experiential knowledge with the aim to balance social work curricula and academic literature with relational learning.

---

**Jaap Bruijn**

Hanze University of Applied Sciences (Netherlands)

## From Political Advocacy to Personal Counselling and Back to Social Activism: The Dutch Journey of Social Work

In recent decades, social work in the Netherlands and other European countries has undergone a remarkable transformation. What once began as politically oriented aid has evolved into a profession in which professionals, through conversations and agogic programs, actively stimulate real change in individuals and their broader systems. Recently, there is a growing recognition among social workers of the social and structural aspects of individual problems, necessitating new approaches and methodologies.

Jaap Bruijn provides an overview of the most recent developments in Dutch social work in his workshop. Using current practical examples, innovative methods that are directly applicable to social workers will be discussed.

This workshop aims to facilitate an exchange of ideas on new approaches in social work, allowing participants to gain insights into refreshing strategies that have a tangible impact on effective help.

---



# Lectures and Workshops

→ Wednesday, 5 June 2024

---

**Tatevik Karapetyan**

Yerevan State University (Armenia)

## Community Based Social Work Centers as Community Integration Hubs in the Context of Displacement

Displacement as a social phenomenon poses numerous challenges for host communities, yet concurrently presents fresh opportunities for their development. Within this context, the models governing the formation of social solidarity and cohesion at the community level, as well as those addressing social issues based on individual capacities, assume paramount significance. A key approach to resolving such challenges lies in the implementation of community centers for social work. These centers not only address the psychosocial and socio-economic concerns of individuals and families but also foster increased levels of social integration and inclusion in the communities accommodating the displaced.

This report focuses on the experiences of seven centers that adopted this model. Established and operational in host communities following the forced displacement of the population of Nagorno Karabakh in September 2023, these centers exemplify effective responses to the multifaceted needs of individuals and families, contributing significantly to the enhancement of social integration and inclusion within the receiving communities.

---

**Amy Kirby**

University of Wisconsin-Milwaukee (USA)

## An Exploration of Trauma-Informed Care: from Milwaukee, Wisconsin to the World

This workshop will establish definitions and descriptions of what trauma-informed care in social work practice looks like in the United States, particularly through the lens of Milwaukee, Wisconsin and one University's social work training emphasis in Trauma-Informed Care (TIC). Participants will be asked to share and explore their understanding of trauma-informed care perspectives and practices within the context of their own local social work systems of their home country. Opportunity will be provided to compare and contrast the ways that trauma-informed care and the populations receiving trauma-informed care services are similar or different across the social service systems represented by participants of the workshop.

---

# Lectures and Workshops

→ Thursday, 6 June 2024

---

**Charlotte Wekker**

Hanze University of Applied Sciences (Netherlands)

## Just kidding! - About Everyday Racism in Higher Vocational Education

Do you wonder to which extent higher vocational education offers equal chances for every student? And are you curious to narratives of racialized students? Then the workshop of Charlotte Wekker might be something for you. Charlotte is a Dutch PhD scholar. Through qualitative research, she gains insight into the power dynamics in education along the lines of skin color. In the workshop she asks questions, gives examples and puts it in the context of theory.

---

**Mikael Bengtsson**

Linnaeus University (Sweden)

## Social Work as a Profession – the Case of Sweden and Other Nations/States

Cross-national perspectives on social work as a profession can bring interesting insights, but sometimes delve into parameters of profession as a category rather than such intricate dynamics that reshape professions in societies. A professions development, or professionalization, could be seen as complex interplay of factors at different levels, both internal and external to the profession. Using Sweden as an example, significant changes in the public sector have profound impact on the profession of social work as well as other professions. While core areas seem even more tied to career entrance and problems with working conditions and competence supply, there has been a notable increase of social worker-educations and social workers by numbers, possibly indicating a growing interest in certain questions and expanding career opportunities in both public and private sector. This lecture will trace pieces of the historical development of social work as a profession in Sweden, and describe its contemporary field of work, positions, and career mobility, while the workshop provides possibilities to discuss and compare the professions development in different nations/states within the frame of the lecture.

---

**Ingrid Baloun / Jana Stejskalová**

Measuring Quality of Life (Czech Republic)

## Measuring Quality of Life

The workshop will focus on measuring quality of life. The students will try out a quality of life questionnaire that we will introduce and then work with. They will measure their own quality of life and then try out measuring quality of life as a social worker with a client.

---





# Lectures and Workshops

→ Thursday, 6 June 2024

---

**Yazmin Mendoza Reyes**

Universidad Panamericana, Campus México (Mexico)

## Community Intervention Model in México with a Measureable social impact

Linking business, government, organizations and civil society to improve living conditions in a specific space over time with a measurable social impact.

---

**Dovilė Daugėlienė**

Vytautas Magnus University (Lithuania)

## Ageism: Definition, Manifestation and Implications

During the workshop students will familiarize themselves with the phenomena of ageism. Main areas where ageism manifest in implicit or explicit way will be discussed, as well as it's implications for older people and society. Students will reflect on their own ageistic attitudes and analyze how they affect their interaction with older people.

---

**Eva Krizova**

Charles University (Czech Republic)

## Spirituality today - Exploratory Techniques and Use in Social Work

The workshop presents spirituality as an optional dimension in social work and demonstrates techniques applicable in the interaction with clients. Spirituality will be presented as a potential but not compulsory dimension in up-to date social work. Students will have the opportunity to creatively investigate their own spirituality by making their own collage and reflect on it in the group

---

# Lectures and Workshops

→ Thursday, 6 June 2024

---

**Terhi Kärpänen/ Outi Loikkanen**

Laurea University of Applied Sciences (Finland)

## The „Service Design for Social Impact“

Social work is a challenging field that involves addressing complex social issues and supporting individuals, families, and communities in need. The „Service Design for Social Impact“ aims to introduce social work students to service design principles and methodologies, empowering them to think innovatively and apply design thinking in addressing real-world challenges within the social work domain.

Through interactive hands-on activities, participants will gain practical skills to innovate traditional social work practices. The workshop emphasizes collaboration, networking, and equips attendees with tools to integrate design thinking into their approach, fostering a more impactful and efficient practice.

---

---

**Sylvia Enríquez Cordero**

Universidad Panamericana, Campus México (Mexico)

## The Importance of Disability Awareness

COLABORE is a program dedicated to the labor and social inclusion of people with disabilities. It presents the way in which the training of university students in the face of disability generates changes in society.

Dynamic: Living disability

---

# Rooms

## Building A - Ground Floor

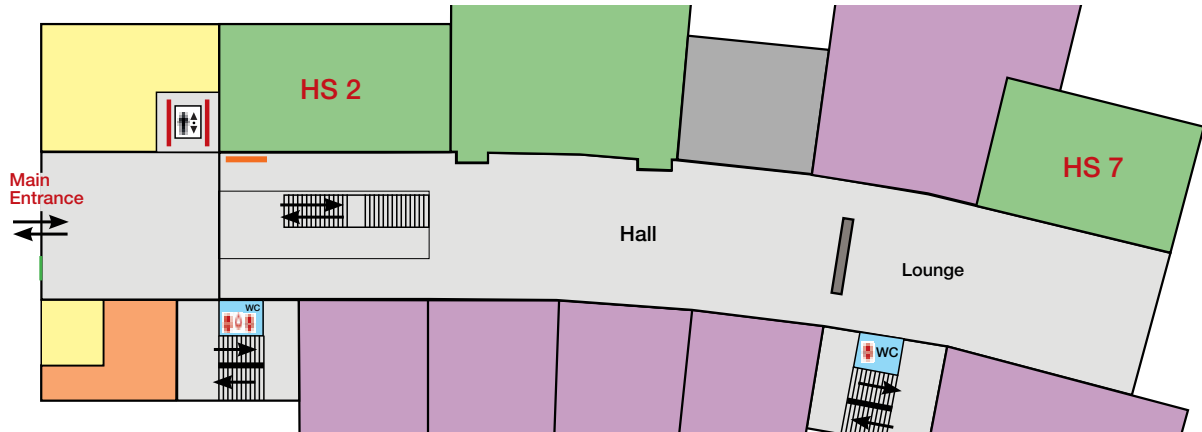

## Building A - Second Floor

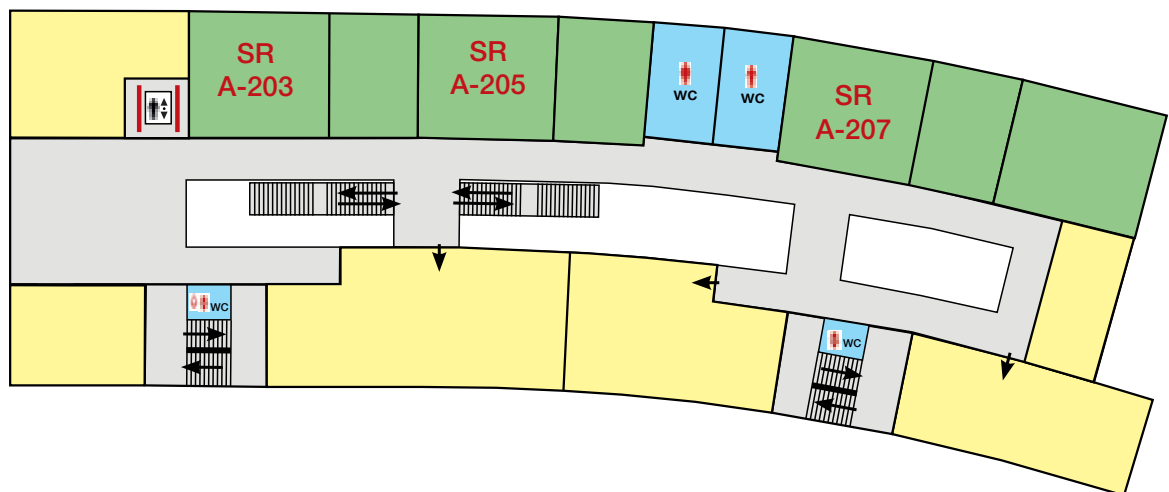

## Building D - Site Plan / First Floor

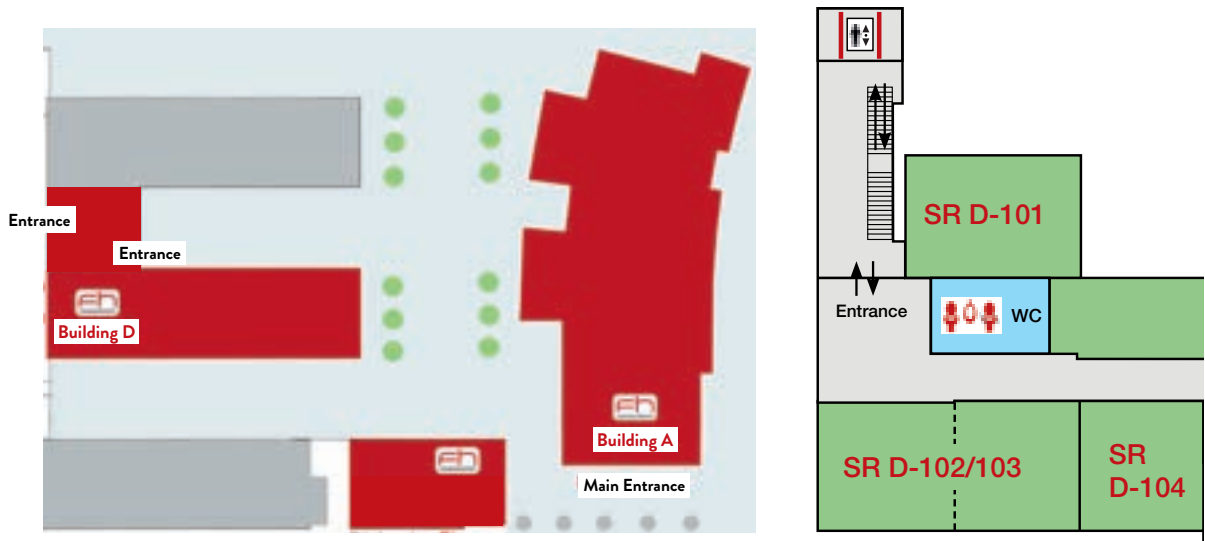

**Aim**





Austria is a small, beautiful country with a great cultural heritage and is located in the very heart of Europe. It is the home of Mozart, Freud, and “The Sound of Music.” Austria’s snowcapped mountains, crystal-clear lakes and rivers, historic cities – Vienna and Salzburg – make it one of the most beautiful places in the world. The economy is very much export oriented and the standard of living is high. Our national language is German, but most people speak some English.

Area:	83,789 km <sup>2</sup>
Population:	9.1 million
Capital:	Vienna
Climate:	temperate; continental; cloudy, cold winters with frequent rain and some snow in the lowlands and snow in mountains; moderate summers with occasional showers
Highest mountain:	Grossglockner, 3,798 m

[www.austria.info/us](http://www.austria.info/us)



No other Austrian city has changed as dramatically as Linz has in recent decades. Linz is a modern urban centre with a flourishing economy, a city where the quality of life is exceptional. In 2009, a trip to Linz was especially rewarding because this city on the Danube was European Capital of Culture and it is indeed a special place.

Linz straddles the Danube and, with a population of 211,000, it is Austria's third largest city. It links the Mühlviertel region, which ends at the Czech border in the north, with the rolling hills that become the Austrian Alps in the south.

The Linz Metropolitan Area is the hub of a thriving regional economy. Here, technology, industry and high sustainability standards are no contradiction: Linz is one of Austria's most environmentally-friendly communities, with green spaces making up 60 % of the city.

Cultural life in Linz is highly diverse, ranging from interactive art at the Ars Electronica Center to 19th- and 20th-century art at the Lentos Kunstmuseum, music at the Brucknerhaus, home of the world-famous Bruckner Orchestra, drama in the Landestheater, opera and musical in the Musiktheater, contemporary art at OK Offenes Kulturhaus Oberösterreich, and exhibits at the Oberösterreichische Landesmuseen (Upper Austria Museums). Here, culture also means history: astronomer Johannes Kepler, composer Anton Bruckner and poet Adalbert Stifter lived in Linz, and Mozart's Linzer Symphony has immortalized the name of the town in which it was composed.

The best way to experience Linz is by strolling around town – across the Hauptplatz or through one of the narrow lanes and inner courtyards of the baroque Old Town below the Castle. A modernized railway climbs Pöstlingberg; at the top, you will be treated to panoramic views of the city, and on a good day, you can see all the way to the Alps. An outing on a Danube cruise ship is another unforgettable experience.

But culture and beautiful scenery aren't all Linz has to offer. Landstrasse is the main street of one of Austria's best and busiest downtown shopping districts. Here there are also restaurants, pubs, and cafes for every taste. Students generally choose the city center, as well as to pubs and restaurants near the Johannes Kepler University. The areas around Hauptplatz, the castle and Landstrasse are especially popular. For spectacular views, try the restaurants on Pöstlingberg, Schlosscafe in the castle, or SkyGarden on the top of Passage shopping center.

[www.linz.at/english/tourism/](http://www.linz.at/english/tourism/)



# Program - Week 2

## → Monday, 10 June 2024

---

- 8:45 Departure from FH Upper Austria
  - 9:30 Historical Site Concentration Camp Mauthausen  
Guided Tour & Visit to Memorial Museum
  - 13:00 Time for reflexion and discussion
  - 14:00 Lunch @ FH Upper Austria
  - 15:30 free time
- 

HS7

## → Tuesday, 11 June 2024

---

- 9:00 Departure from FH Upper Austria
  - 10:00 Mayer Schokolade
  - 14:00 Alpaka Lunch
  - 16:00 free time
- 

## → Wednesday, 12 June 2024

---

- 9:00 Departure from FH Upper Austria
  - 10:00 Verein Substanz (Substance Abuse & Harm Reduction Counselling Center)
  - 12:00 Lunch - Restaurant Kontrast
  - 14:00 Prevention Center (Counselling for Female Victims)
  - 15:30 free time
- 

HS7

## → Thursday, 13 June 2024

---

- 9:30 Workshop SOS Human Rights (Social Work with Asylum Seekers)
  - 13:00 Lunch @ FH Upper Austria - Pizza Day
  - 14:00 "Drugs and Addiction in Upper Austria": Thomas Schwarzenbrunnerr
  - 15:30 free time
- 

SR A-104/105

SR A-104/105

## → Friday, 14 June 2024

---

- 9:00 Departure from FH Upper Austria
  - 10:00 Lebenshilfe Upper Austria, Steyr (Services for people with intellectual disabilities) – presentation and tour of the facility (living and work place)
  - 12:00 Farewell Lunch Restaurant Gorfer (Garsten)
  - 14:00 Visit to Garsten Prison: presentation by Social Worker Julian Losbichler & prison tour
-

# Visit us at Campus Linz.



**Aim**

→ **higher**

University of Applied Sciences Upper Austria  
School of Medical Engineering & Applied Social Sciences  
Garnisonstrasse 21, 4020 Linz/Austria  
Tel.: +43 5 0804 54060, [international@fh-linz.at](mailto:international@fh-linz.at)  
<https://fh-ooe.at/en>



UNIVERSITY  
OF APPLIED SCIENCES  
UPPER AUSTRIA