

**Zusätzliche Räumlichkeiten der Fakultät im Softwarepark:**

- |   |   |    |   |
|---|---|----|---|
| 1 | Studentenheim 3 (SH3), Ebene 0<br>ÖH Students' Corner   | 9  | IT Center<br>FH OÖ coworking Bytewerk   |
| 2 | Studentenheim 2 (SH2)<br>Küche für Studierende          | 10 | Studentenheim 1 (SH1)<br>Lager  |
| 3 | Studentenheim 4 (SH4), Ebene 0<br>Archiv                | 11 | Studentenheim 2 (SH2)<br>Betriebsrat, F&E, Research Center<br>Labs, General Production Room |
| 4 | HSD Seminarraum SH02                                    | 12 | Studentenheim 2 (SH2) + 3 (SH3)<br>Research Center Labs, Büros                              |
| 5 | Lern- und Kommunikationsraum<br>(LeKom) für Studierende | 13 | Meierhof<br>Research Center Labs, Büros   |
| 6 | Studentenheim 6 (SH6), Ebene 0 und 1                    |    |   |
| 7 | PIE-Lab   |    |   |
| 8 | Projektraum OP  |    |   |

**Gastronomie (Menüs: [www.heute-mittag.at](http://www.heute-mittag.at)):**

- |   |                                |   |                       |   |                       |
|---|--------------------------------|---|-----------------------|---|-----------------------|
| A | Mensa Campina                  | E | Restaurant Park       | I | Gasthaus Hametner     |
| B | Pub Loungerie                  | F | Bäckerei/Cafe Honeder | J | Café Monika           |
| C | Burgerei                       | G | Schlossrestaurant     | K | Vorstadt-Wirt Chili   |
| D | Restaurant<br>Salz und Pfeffer | H | Pizzeria Lavinya      | L | Food Truck Hanselmann |

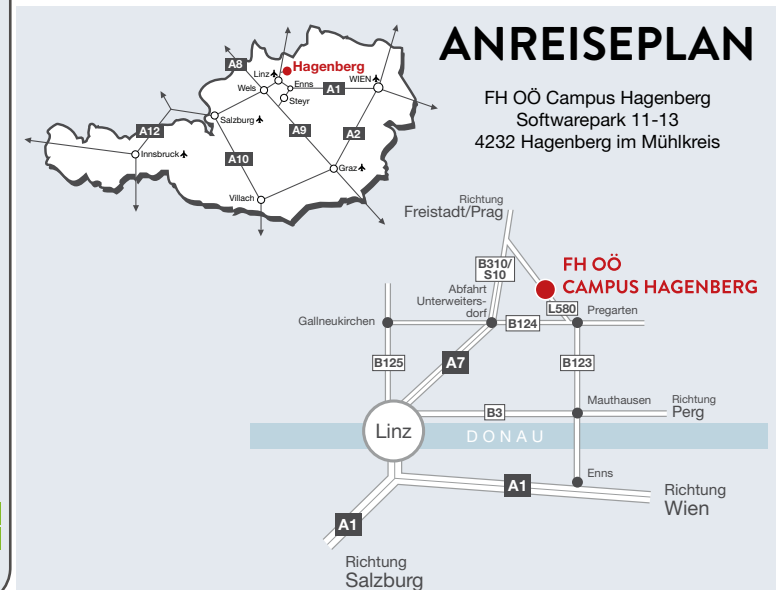

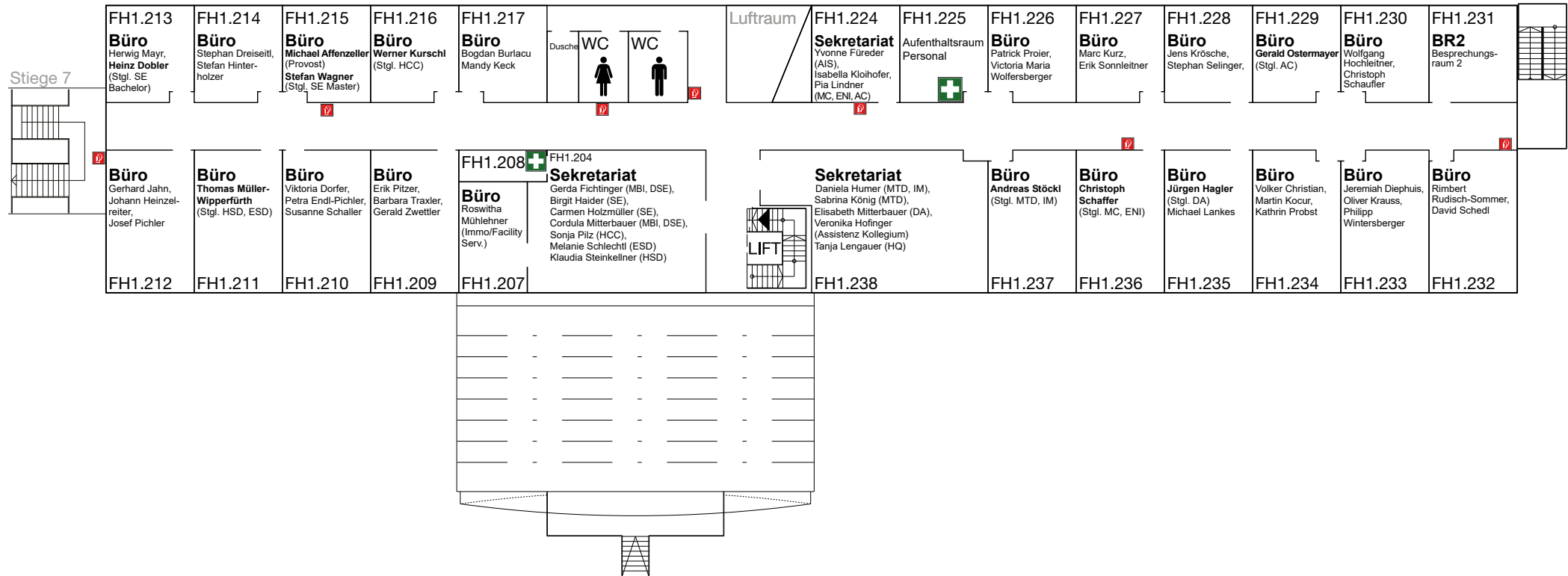

FH-Gebäude 1 Ebene 2

MBI/DSE	SE/HCC/IEM	SIB/SIM/ISM	HSD/ESD	SAIL AC/DDP/MC/ENI	KWM	MTD/DA/IM
Medizin- und Bioinformatik, Data Science und Engineering	Software Engineering, Human-Centered Computing, Information Engineering und -Management	Sichere Informationssysteme (Bachelor/Master), Information Security Management	Hardware-Software-Design, Embedded Systems Design	Automotive Computing, Design of Digital Products, Mobile Computing (Ba/Ma), Energy Informatics	Kommunikation, Wissen, Medien (Bachelor/Master)	Medientechnik und -design, Digital Arts (Bachelor/Master), Interactive Media

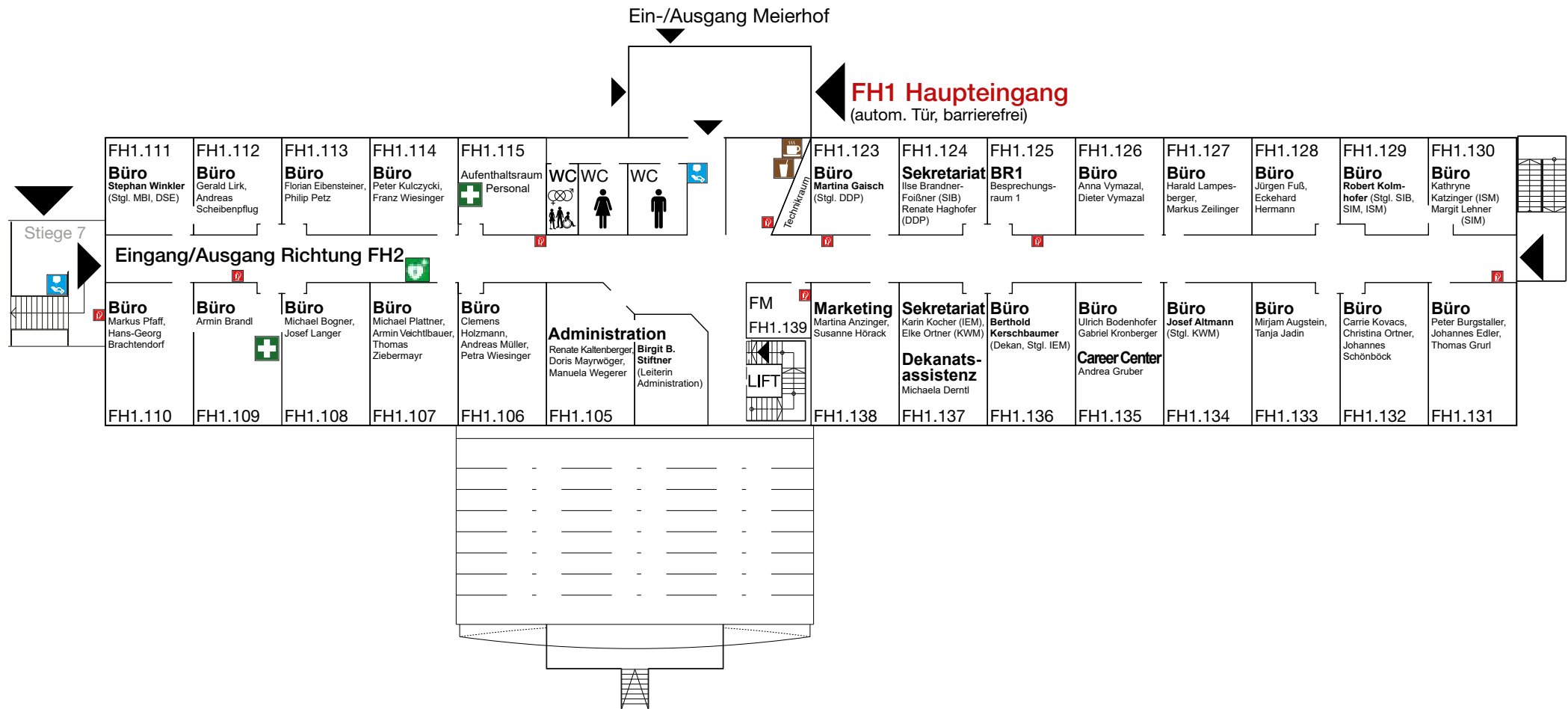

FH-Gebäude 1 Ebene 1

MBI/DSE	SE/HCC/IEM	SIB/SIM/ISM	HSD/ESD	SAIL AC/DDP/MC/ENI	KWM	MTD/DA/IM
Medizin- und Bioinformatik, Data Science und Engineering	Software Engineering, Human-Centered Computing, Information Engineering und -Management	Sichere Informationssysteme (Bachelor/Master), Information Security Management	Hardware-Software-Design, Embedded Systems Design	Automotive Computing, Design of Digital Products, Mobile Computing (Ba/Ma), Energy Informatics	Kommunikation, Wissen, Medien (Bachelor/Master)	Medientechnik und -design, Digital Arts (Bachelor/Master), Interactive Media

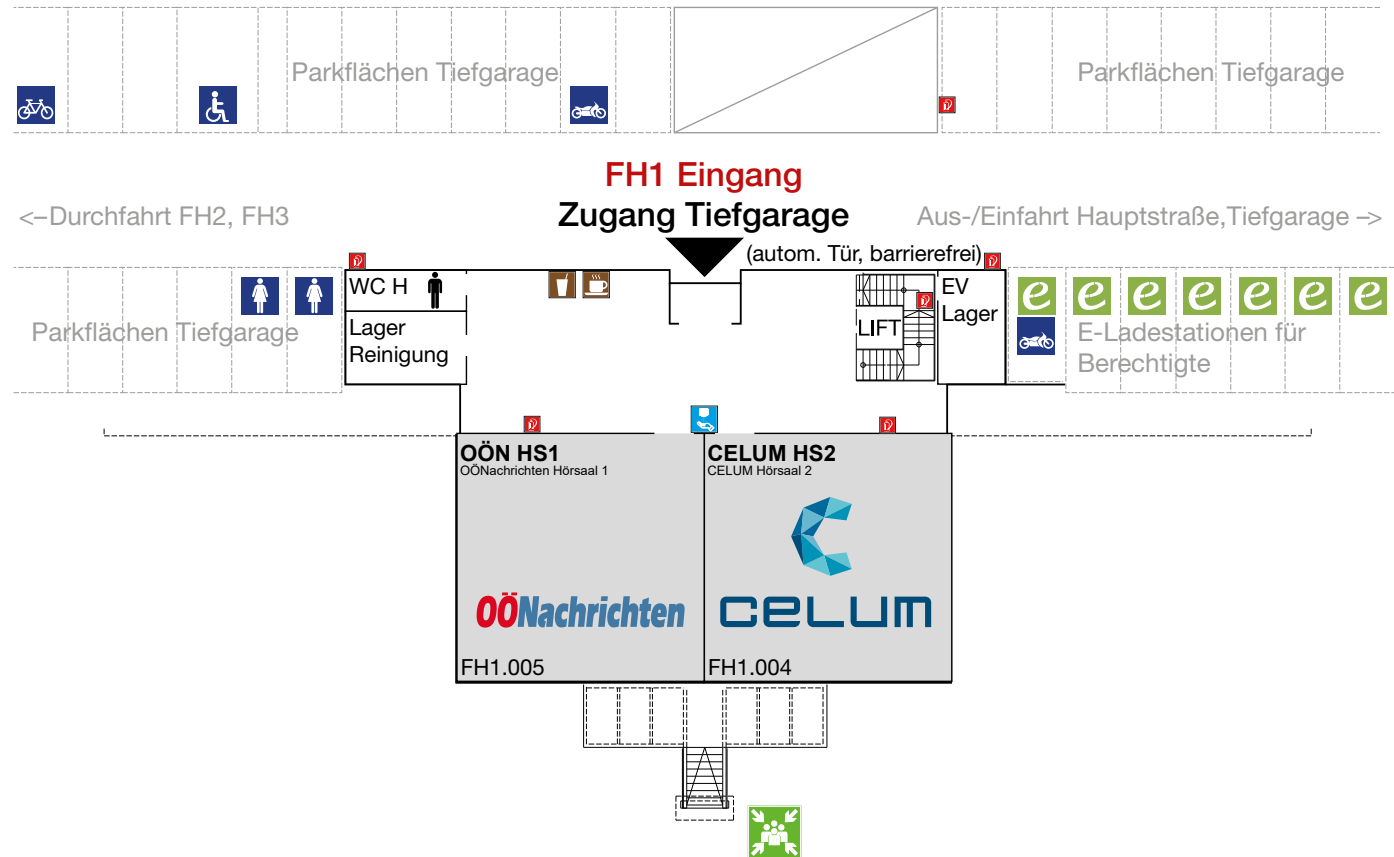

FH-Gebäude 1 Ebene 0

MBI/DSE	SE/HCC/IEM	SIB/SIM/ISM	HSD/ESD	SAIL AC/DDP/MC/ENI	KWM	MTD/DA/IM
Medizin- und Bioinformatik, Data Science und Engineering	Software Engineering, Human-Centered Computing, Information Engineering und -Management	Sichere Informationssysteme (Bachelor/Master), Information Security Management	Hardware-Software-Design, Embedded Systems Design	Automotive Computing, Design of Digital Products, Mobile Computing (Ba/Ma), Energy Informatics	Kommunikation, Wissen, Medien (Bachelor/Master)	Medientechnik und -design, Digital Arts (Bachelor/Master), Interactive Media

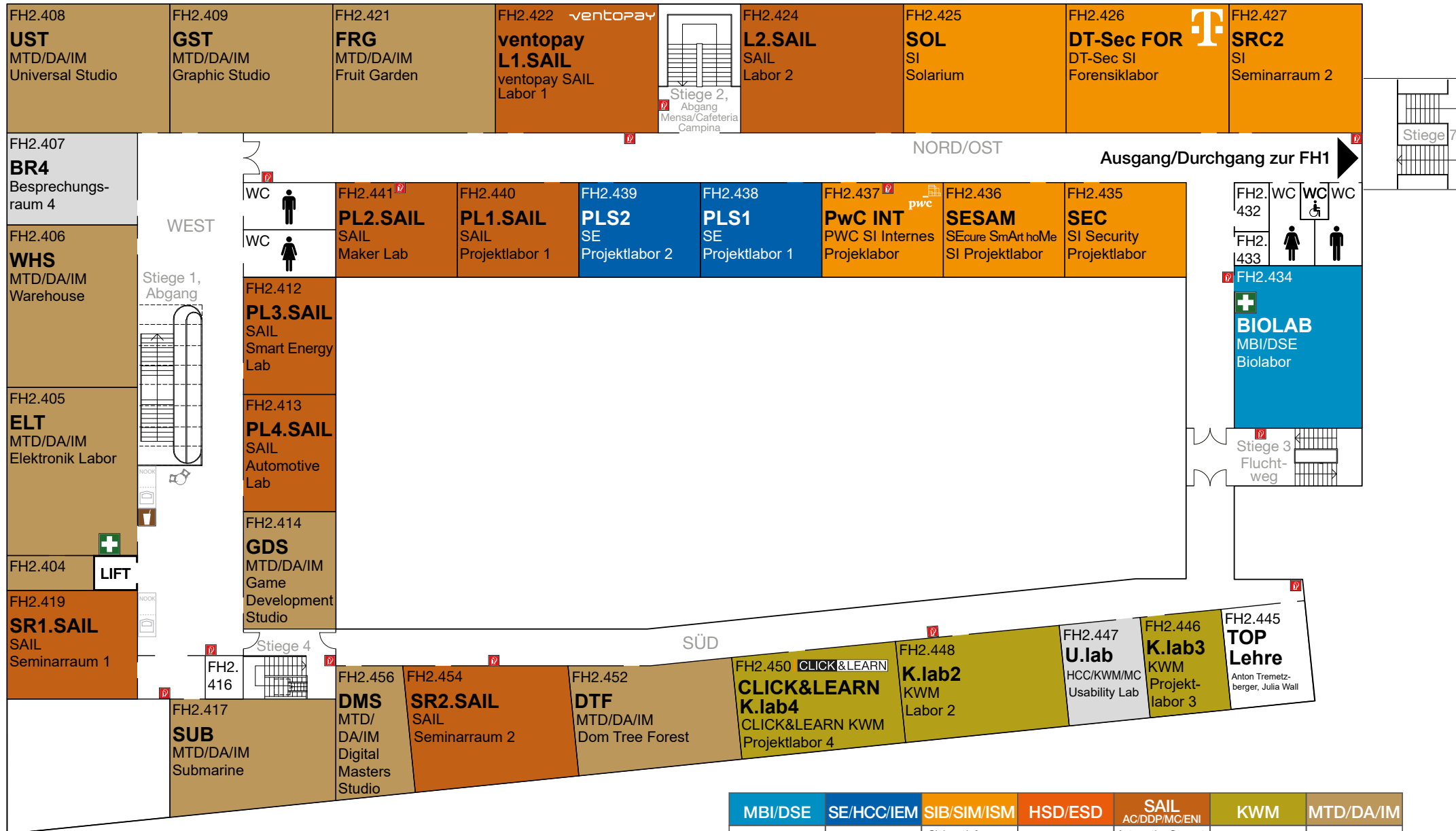

FH-Gebäude 2 Ebene 4

MBI/DSE	SE/HCC/IEM	SIB/SIM/ISM	HSD/ESD	SAIL AC/DDP/MC/ENI	KWM	MTD/DA/IM
Medizin- und Bioinformatik, Data Science und Engineering	Software Engineering, Human-Centered Computing, Information Engineering und -Management	Sichere Informationssysteme (Bachelor/Master), Information Security Management	Hardware-Software-Design, Embedded Systems Design	Automotive Computing, Design of Digital Products, Mobile Computing (Ba/Ma), Energy Informatics	Kommunikation, Wissen, Medien (Bachelor/Master)	Medientechnik und -design, Digital Arts (Bachelor/Master), Interactive Media

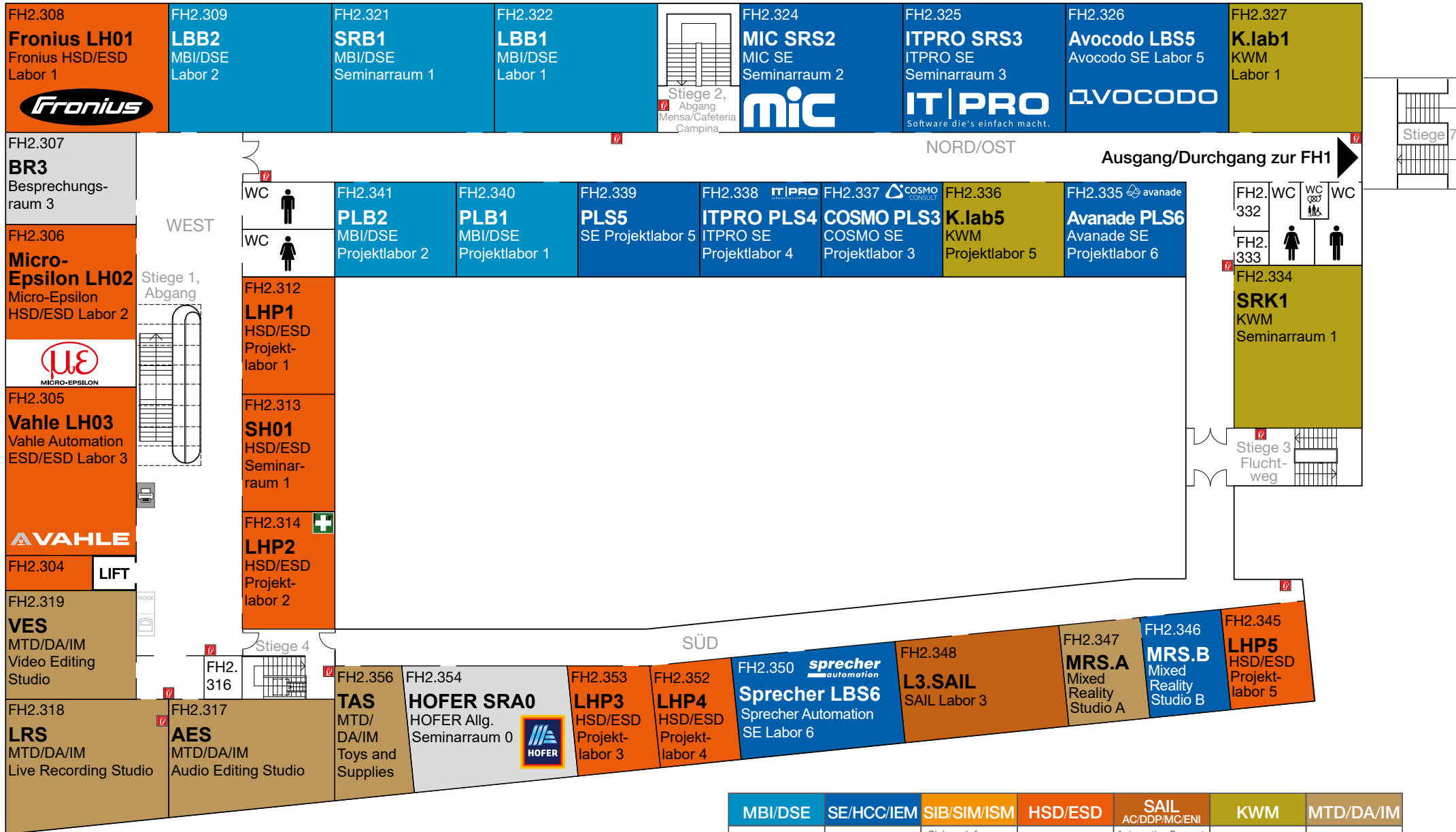

FH-Gebäude 2 Ebene 3

MBI/DSE	SE/HCC/IEM	SIB/SIM/ISM	HSD/ESD	SAIL AC/DDP/MC/ENI	KWM	MTD/DA/IM
Medizin- und Bioinformatik, Data Science und Engineering	Software Engineering, Human-Centered Computing, Information Engineering und -Management	Sichere Informationssysteme (Bachelor/Master), Information Security Management	Hardware-Software-Design, Embedded Systems Design	Automotive Computing, Design of Digital Products, Mobile Computing (Ba/Ma), Energy Informatics	Kommunikation, Wissen, Medien (Bachelor/Master)	Medientechnik und -design, Digital Arts (Bachelor/Master), Interactive Media

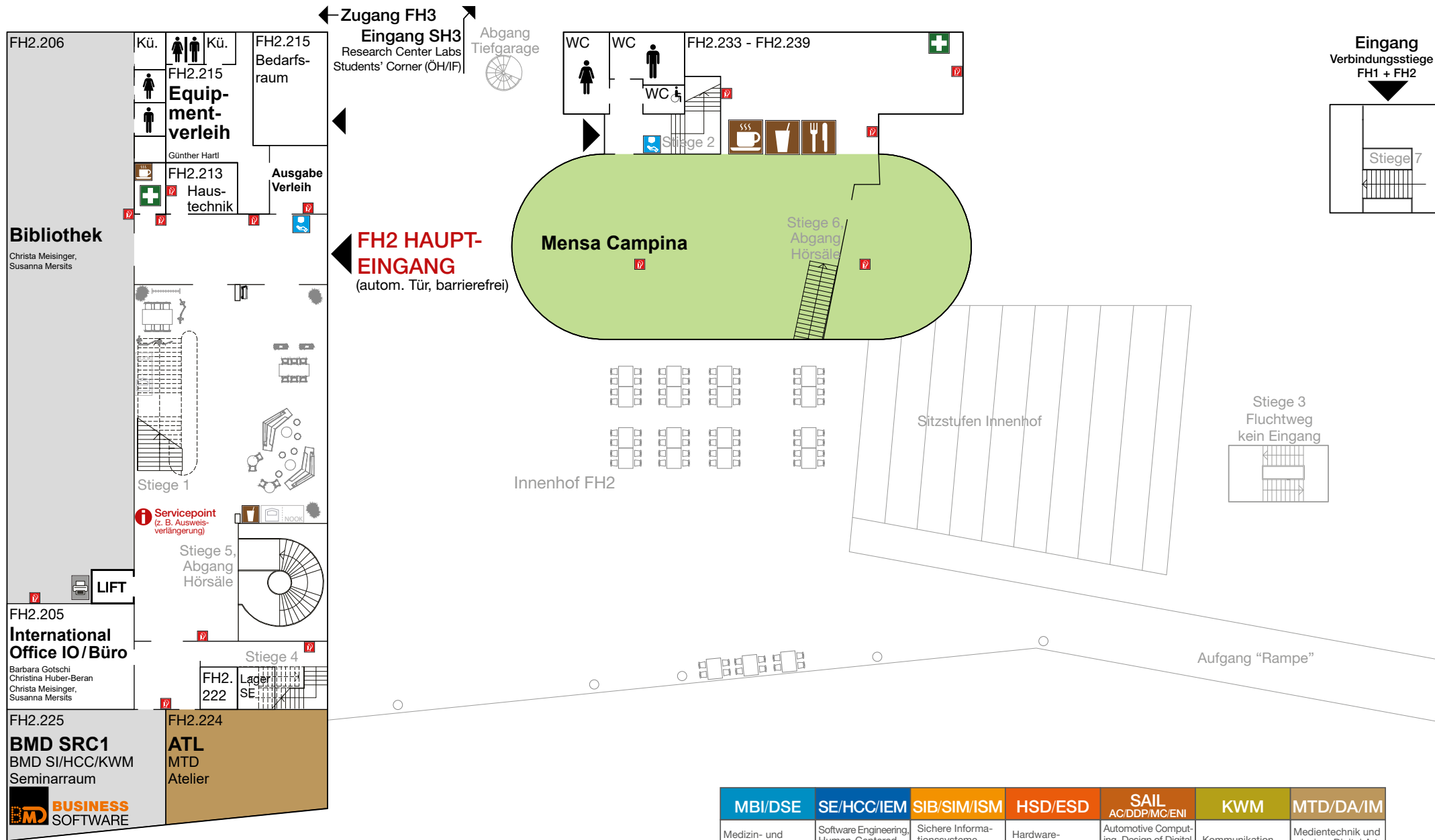

FH-Gebäude 2 Ebene 2

MBI/DSE	SE/HCC/IEM	SIB/SIM/ISM	HSD/ESD	SAIL AC/DDP/MC/ENI	KWM	MTD/DA/IM
Medizin- und Bioinformatik, Data Science und Engineering	Software Engineering, Human-Centered Computing, Information Engineering und -Management	Sichere Informationssysteme (Bachelor/Master), Information Security Management	Hardware-Software-Design, Embedded Systems Design	Automotive Computing, Design of Digital Products, Mobile Computing (Ba/Ma), Energy Informatics	Kommunikation, Wissen, Medien (Bachelor/Master)	Medientechnik und -design, Digital Arts (Bachelor/Master), Interactive Media

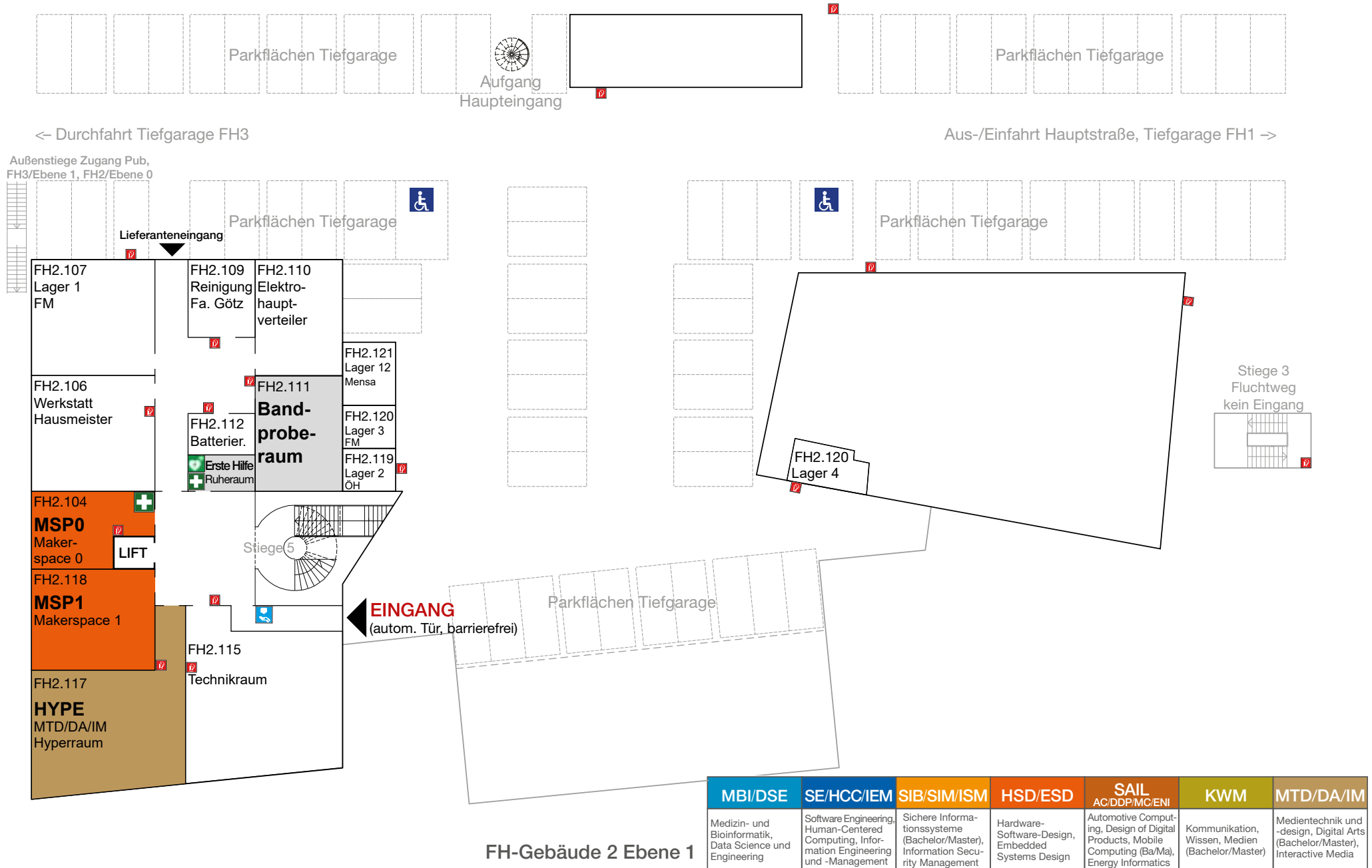

FH-Gebäude 2 Ebene 1

MBI/DSE	SE/HCC/IEM	SIB/SIM/ISM	HSD/ESD	SAIL AC/DDP/MC/ENI	KWM	MTD/DA/IM
Medizin- und Bioinformatik, Data Science und Engineering	Software Engineering, Human-Centered Computing, Information Engineering und -Management	Sichere Informationssysteme (Bachelor/Master), Information Security Management	Hardware-Software-Design, Embedded Systems Design	Automotive Computing, Design of Digital Products, Mobile Computing (Ba/Ma), Energy Informatics	Kommunikation, Wissen, Medien (Bachelor/Master)	Medientechnik und -design, Digital Arts (Bachelor/Master), Interactive Media



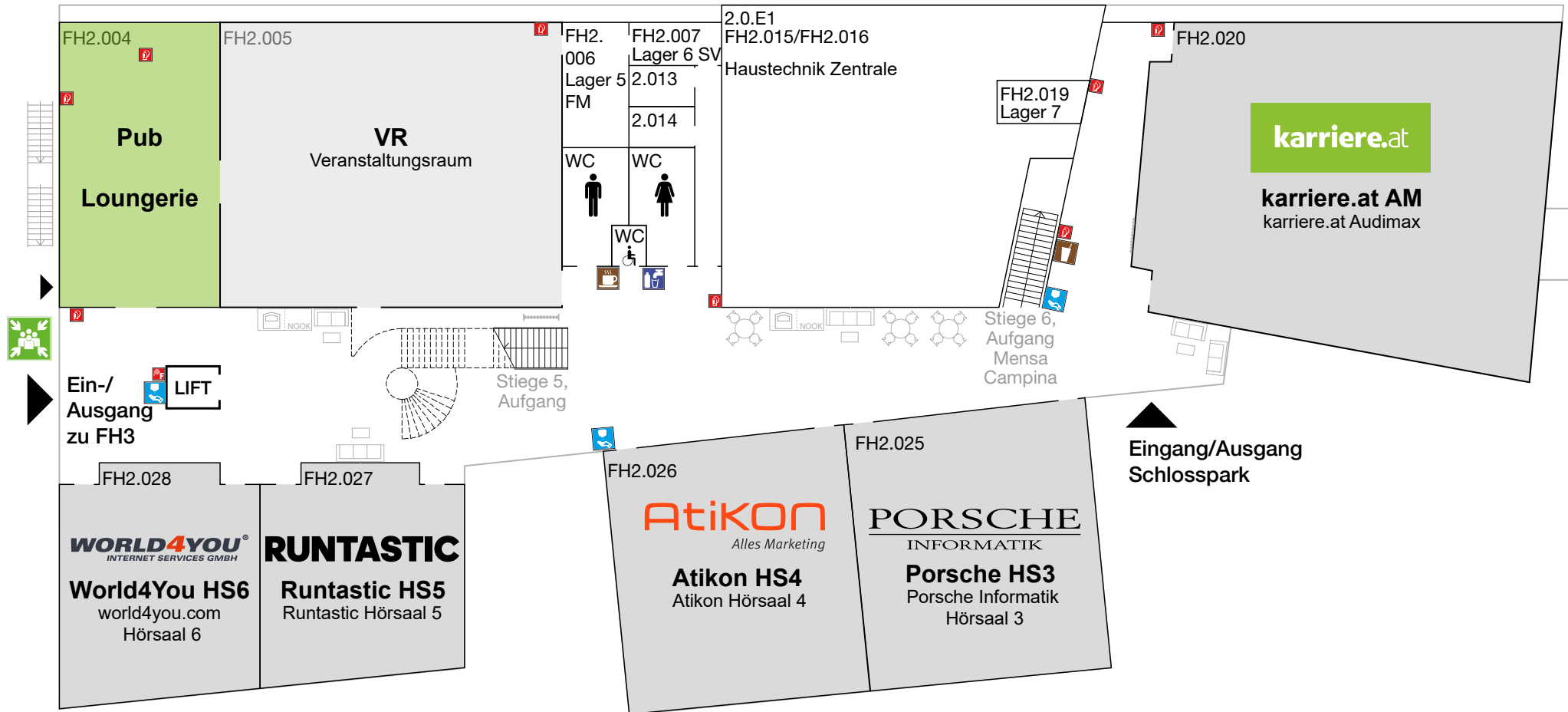

FH-Gebäude 2 Ebene 0

MBI/DSE	SE/HCC/IEM	SIB/SIM/ISM	HSD/ESD	SAIL AC/DDP/MC/ENI	KWM	MTD/DA/IM
Medizin- und Bioinformatik, Data Science und Engineering	Software Engineering, Human-Centered Computing, Information Engineering und -Management	Sichere Informationssysteme (Bachelor/Master), Information Security Management	Hardware-Software-Design, Embedded Systems Design	Automotive Computing, Design of Digital Products, Mobile Computing (Ba/Ma), Energy Informatics	Kommunikation, Wissen, Medien (Bachelor/Master)	Medientechnik und -design, Digital Arts (Bachelor/Master), Interactive Media

# FH3 EBENE 5

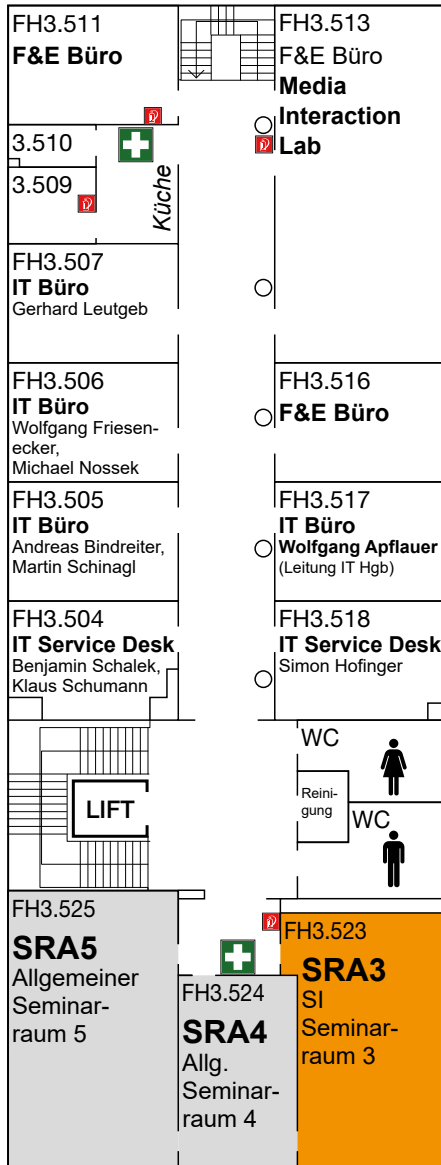

FH-Gebäude 3 Ebene 5

# FH3 EBENE 4

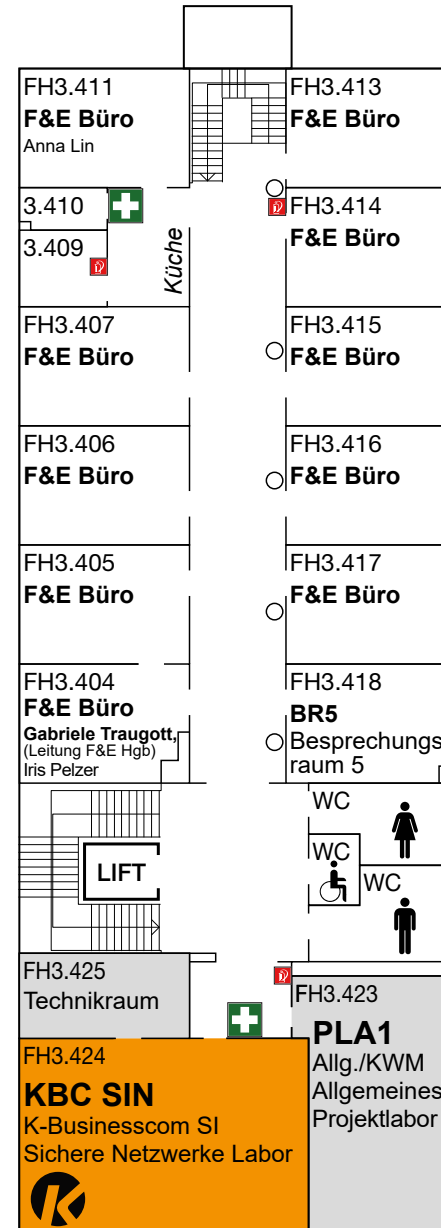

FH-Gebäude 3 Ebene 4

# FH3 EBENE 3

## FH3 HAUPTINGANG

(autom. Tür, barrierefrei)

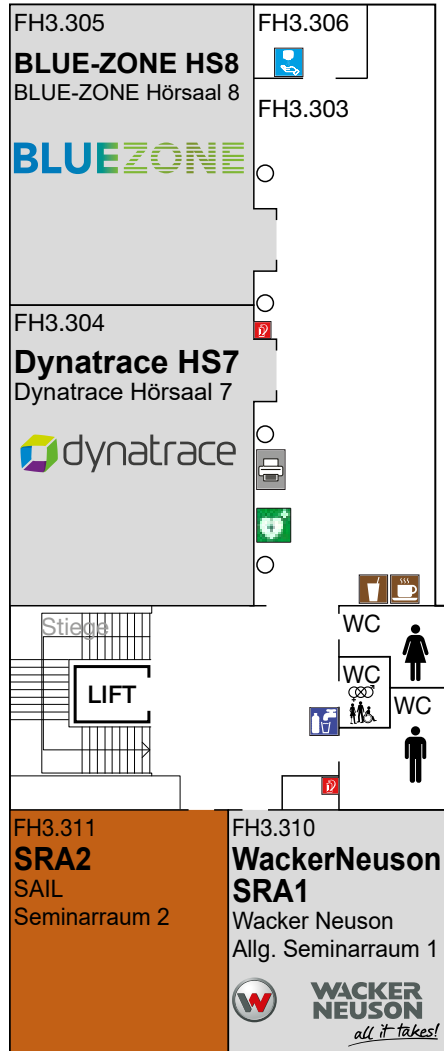

FH-Gebäude 3 Ebene 3

# FH3 EBENE 2

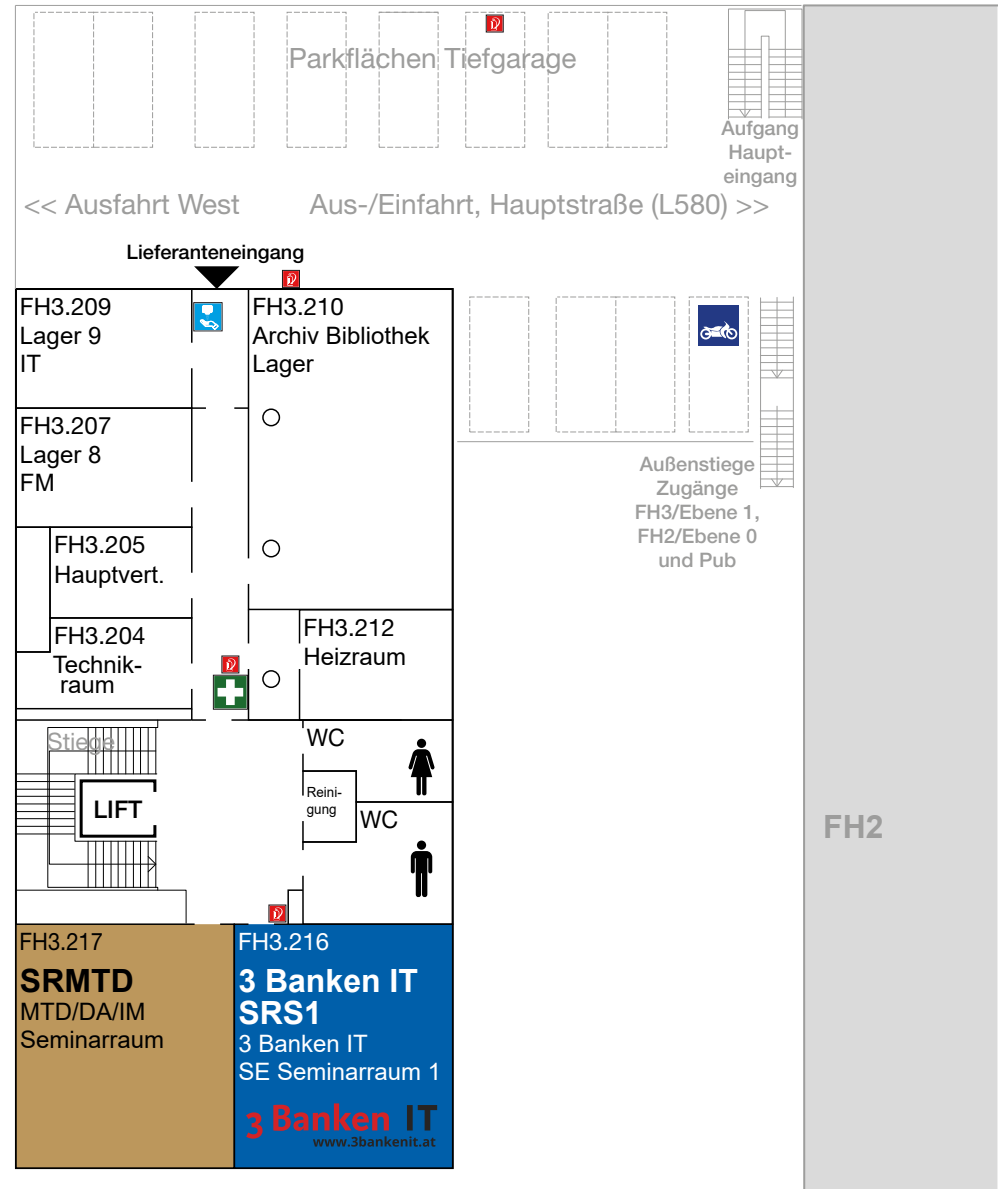

FH-Gebäude 3 Ebene 2

# FH3 EBENE 1

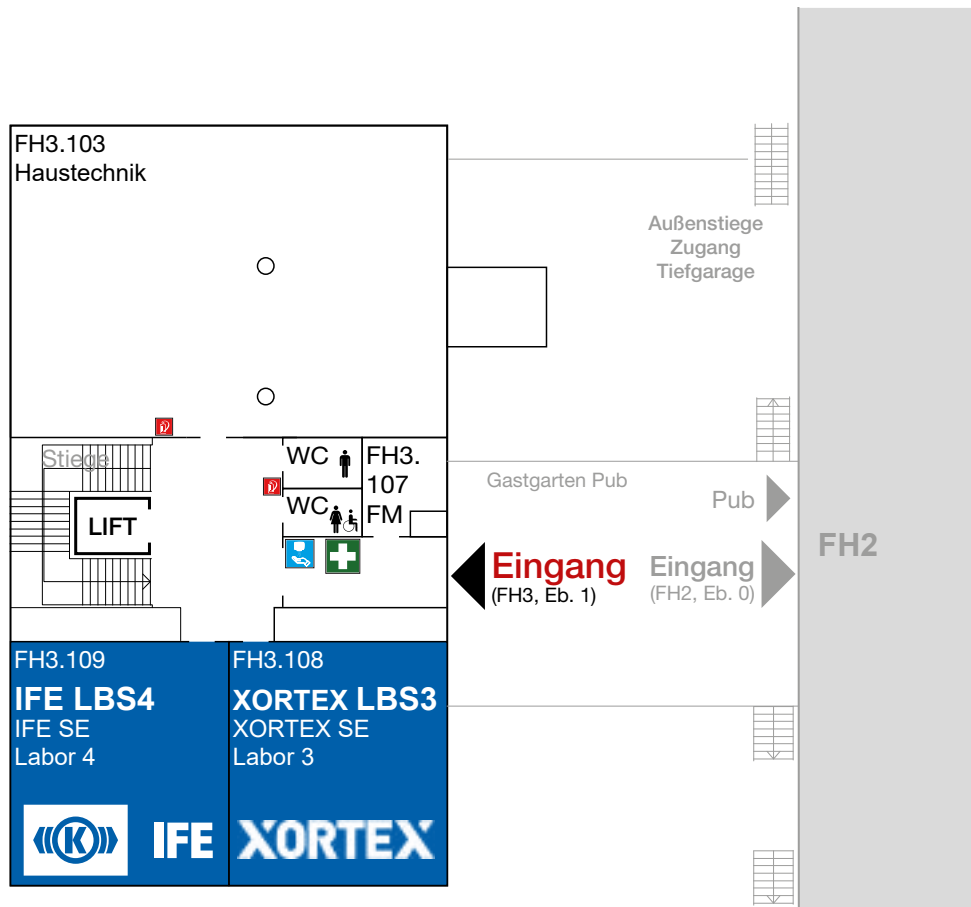

FH-Gebäude 3 Ebene 1

# FH3 EBENE 0

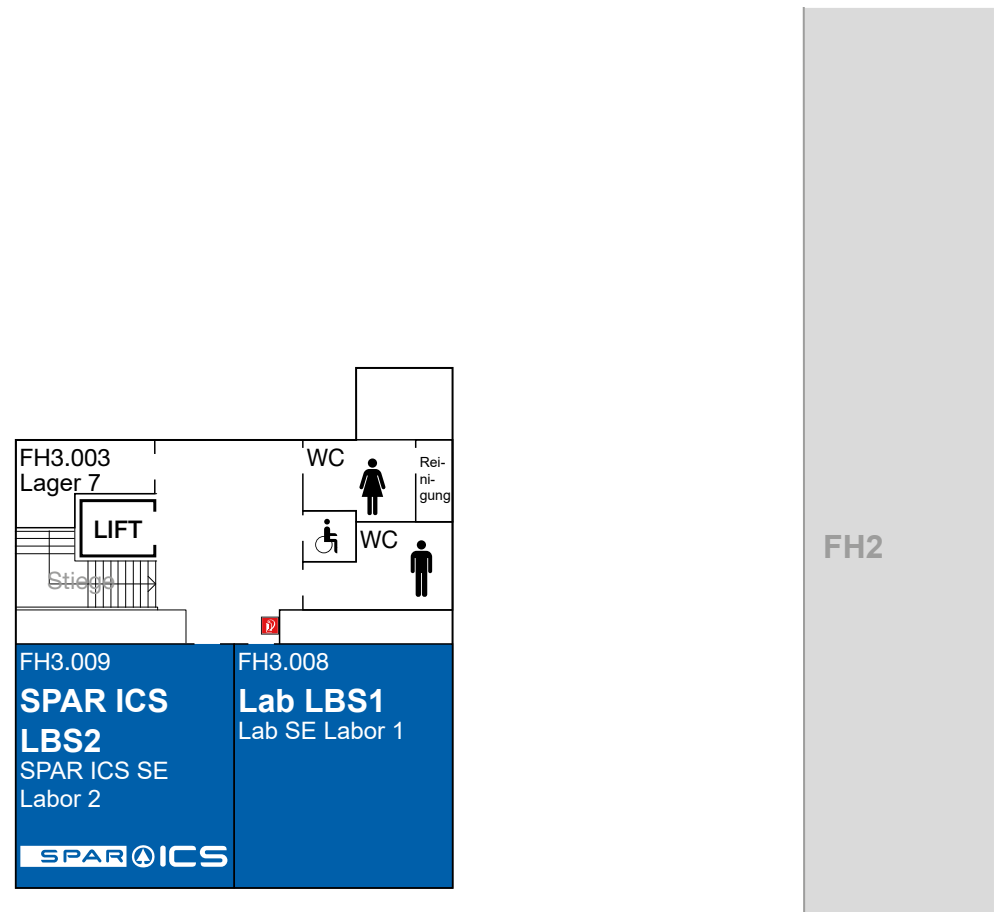

FH-Gebäude 3 Ebene 0

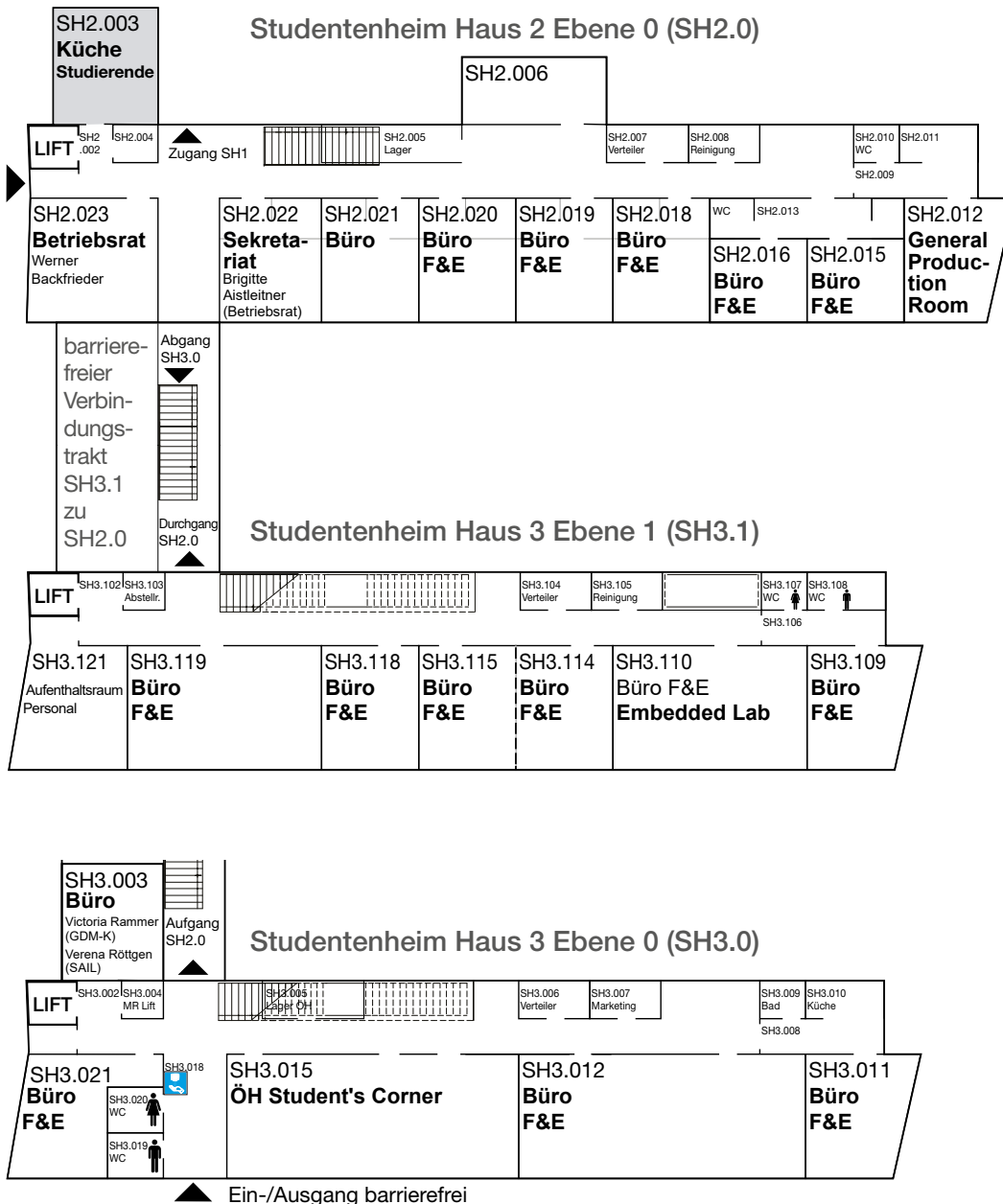

Zur Information: Die Gebäudeteile Studentenheim Haus 2 Ebene 0 (SH2.0) und Studentenheim Haus 3 Ebene 1 (SH3.1) sind innen barrierefrei verbunden. Der barrierefreie Zugang zu Haus 2 (SH2.0) ist somit über den Haupteingang Studentenheim Haus 3 (SH3) möglich: mit dem Lift SH3 auf Ebene 1 fahren und dann Durchgang zu SH2.0 benutzen.

## Studentenheim Haus 3 Ebene 2 (SH3.2)

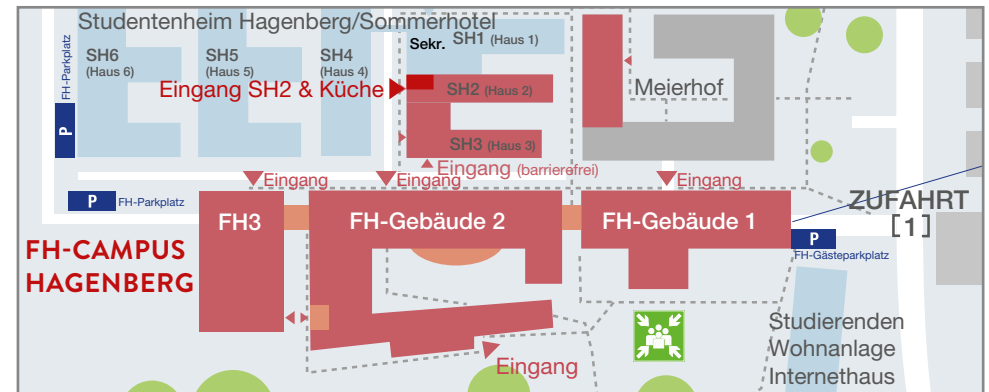
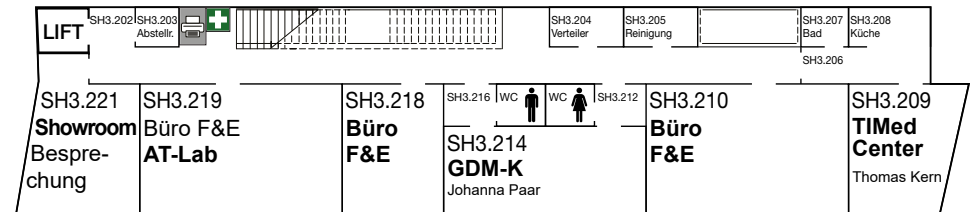

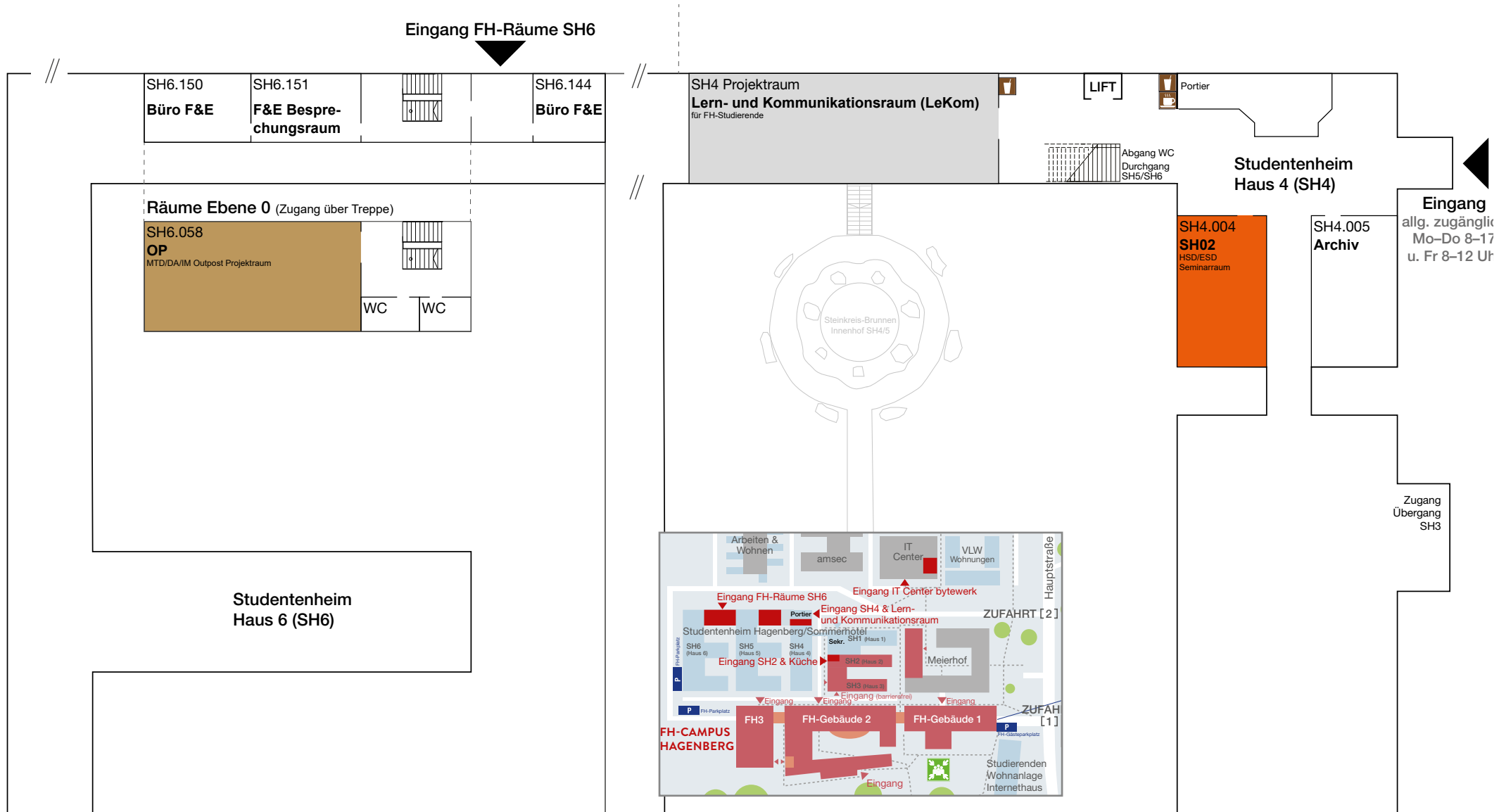

Studentenheim Haus 6 Ebene 1/0 (Softwarepark 23, Zugang FH-Räume Nordseite gegenüber „Arbeiten & Wohnen“)

Studentenheim Haus 4 (Softwarepark 23 Zugang FH-Räume Haupteingang/Portier)

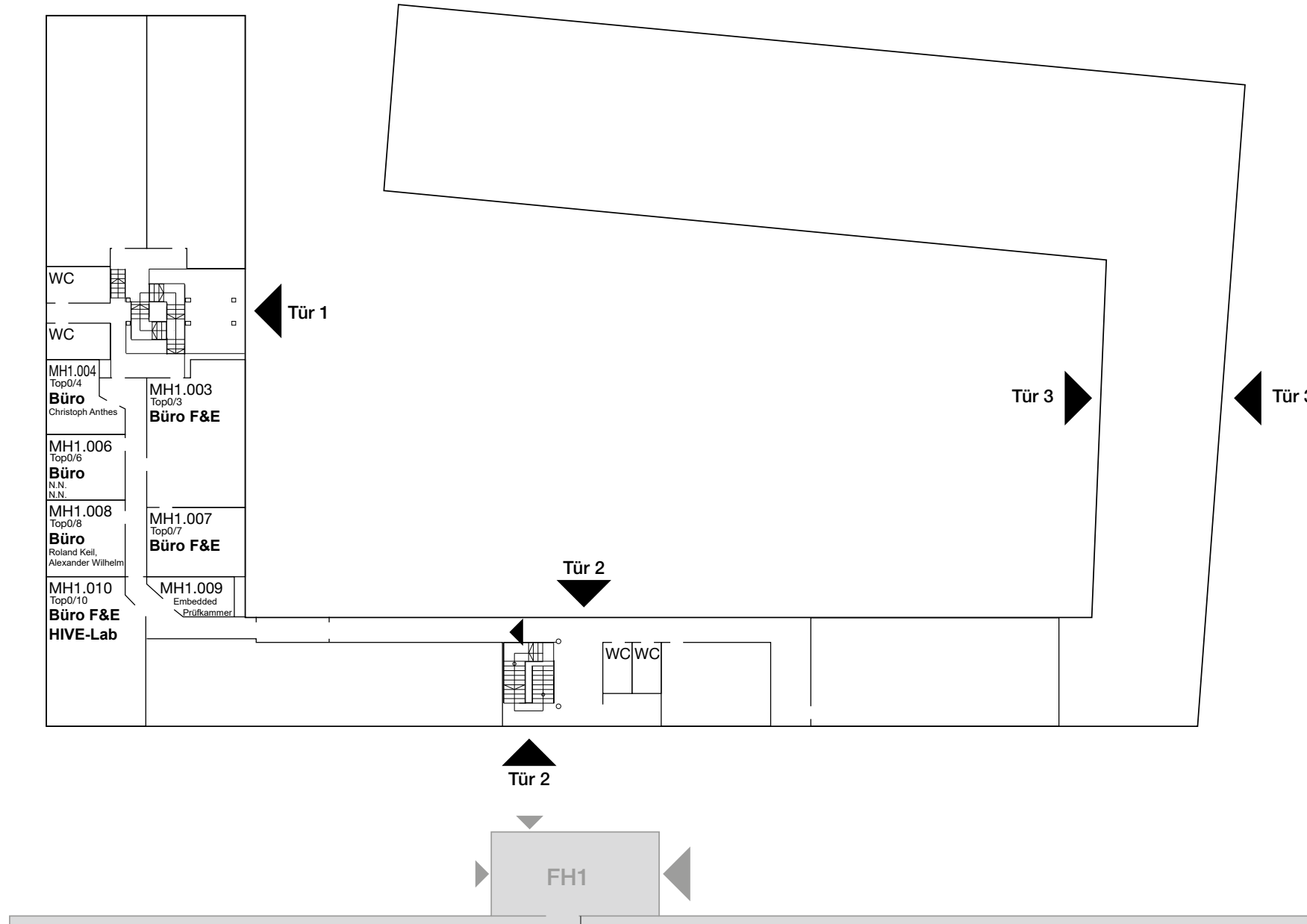

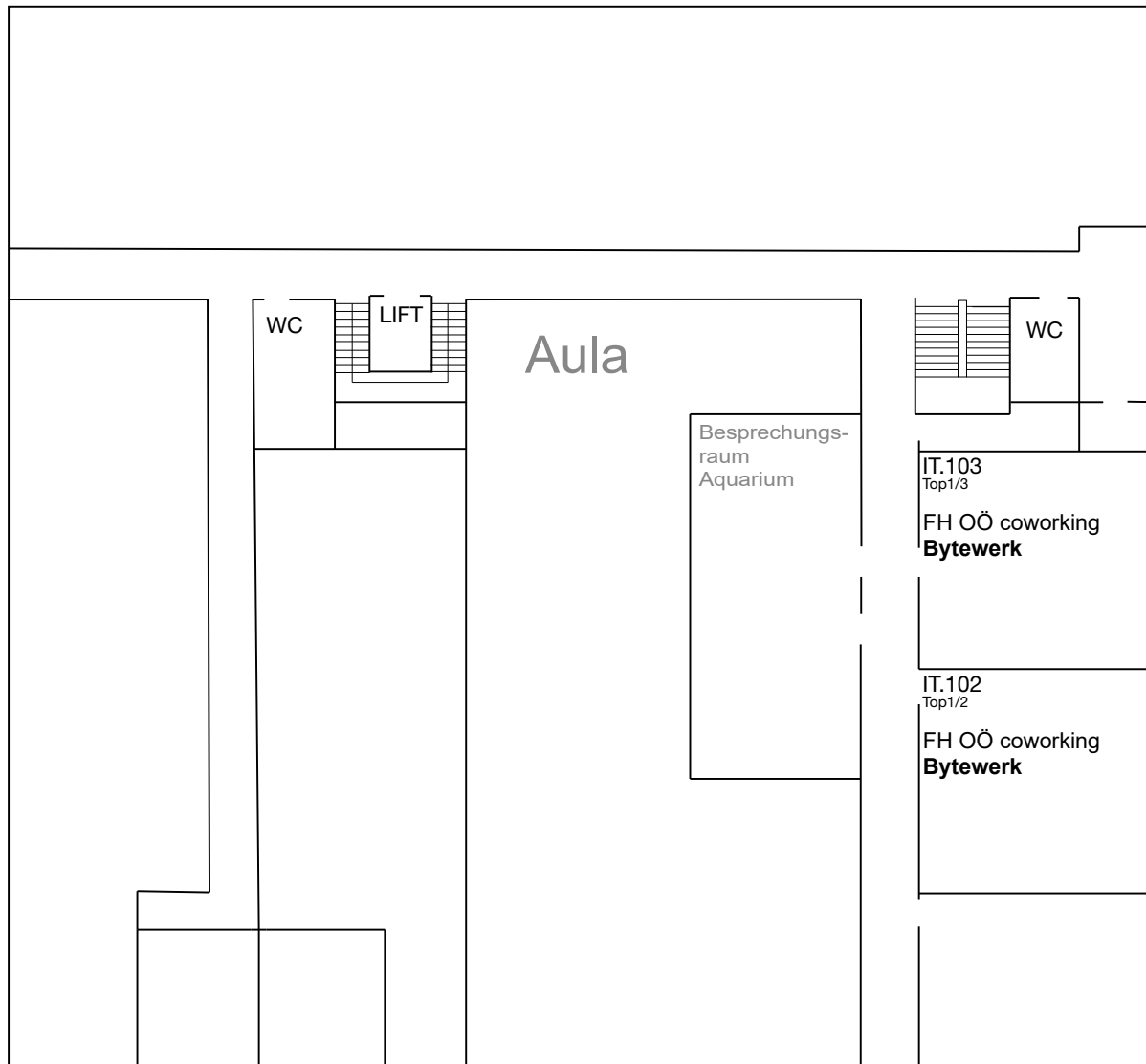

▲  
Eingang Erdgeschoss (Ebene 0)

IT Center Ebene 1

